

Shoulder Leader Pins - Guided Ejector

- Provide initial alignment of cavity and core halves
- Press-fit installation
- Tolerances allow for mating with any standard PCS bushings
- Case hardened steel
- Designed for 7/8" Bottom Clamp Plate

Leader Pins provide initial alignment of cavity and core halves. PCS Shoulder Guided Ejector Leader Pins are manufactured from 4150 steel. These pins come standard with a 7/8" press-fit length. These leader pins can be used with PCS standard bushings.



SPECIFICATIONS

Hardness	Case Hardened 58-60 Rc
Material Type	4150
Unit of Measure	Inch

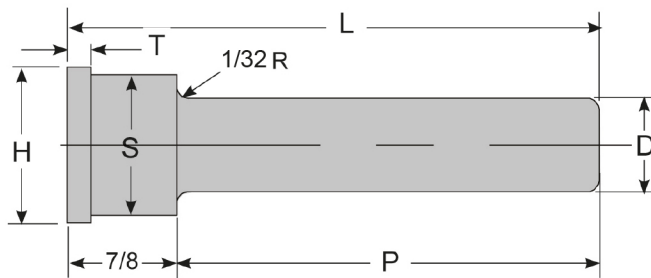

CATALOG NO.	NOMINAL DIA.	ACTUAL PIN DIAMETER +.0000 / -.0005	S PRESS FIT DIAMETER +.0005/- .0000	P PIN LENGTH	L OVERALL LENGTH -.030/- .060	H HEAD DIAMETER +.000/- .010	T HEAD THICK +.000/- .015
004-GSP	1/2	0.499	0.751	2-7/8	3-3/4	0.853	.187
005-GSP		0.499	0.751	3-3/8	4-1/4	0.853	.187
006-GSP		0.499	0.751	3-7/8	4-3/4	0.853	.187
007-GSP		0.499	0.751	4-3/8	5-1/4	0.853	.187
105-GSP	3/4	0.749	1.126	3-3/8	4-1/4	1.250	.312
106-GSP		0.749	1.126	3-7/8	4-3/4	1.250	.312
107-GSP		0.749	1.126	4-3/8	5-1/4	1.250	.312
108-GSP		0.749	1.126	4-7/8	5-3/4	1.250	.312
305-GSP	1	0.999	1.376	3-3/8	4-1/4	1.500	.312
306-GSP		0.999	1.376	3-7/8	4-3/4	1.500	.312
307-GSP		0.999	1.376	4-3/8	5-1/4	1.500	.312
308-GSP		0.999	1.376	4-7/8	5-3/4	1.500	.312